

**Layout Plan**  
**Retaining Wall RW 5**  
M=1:1000

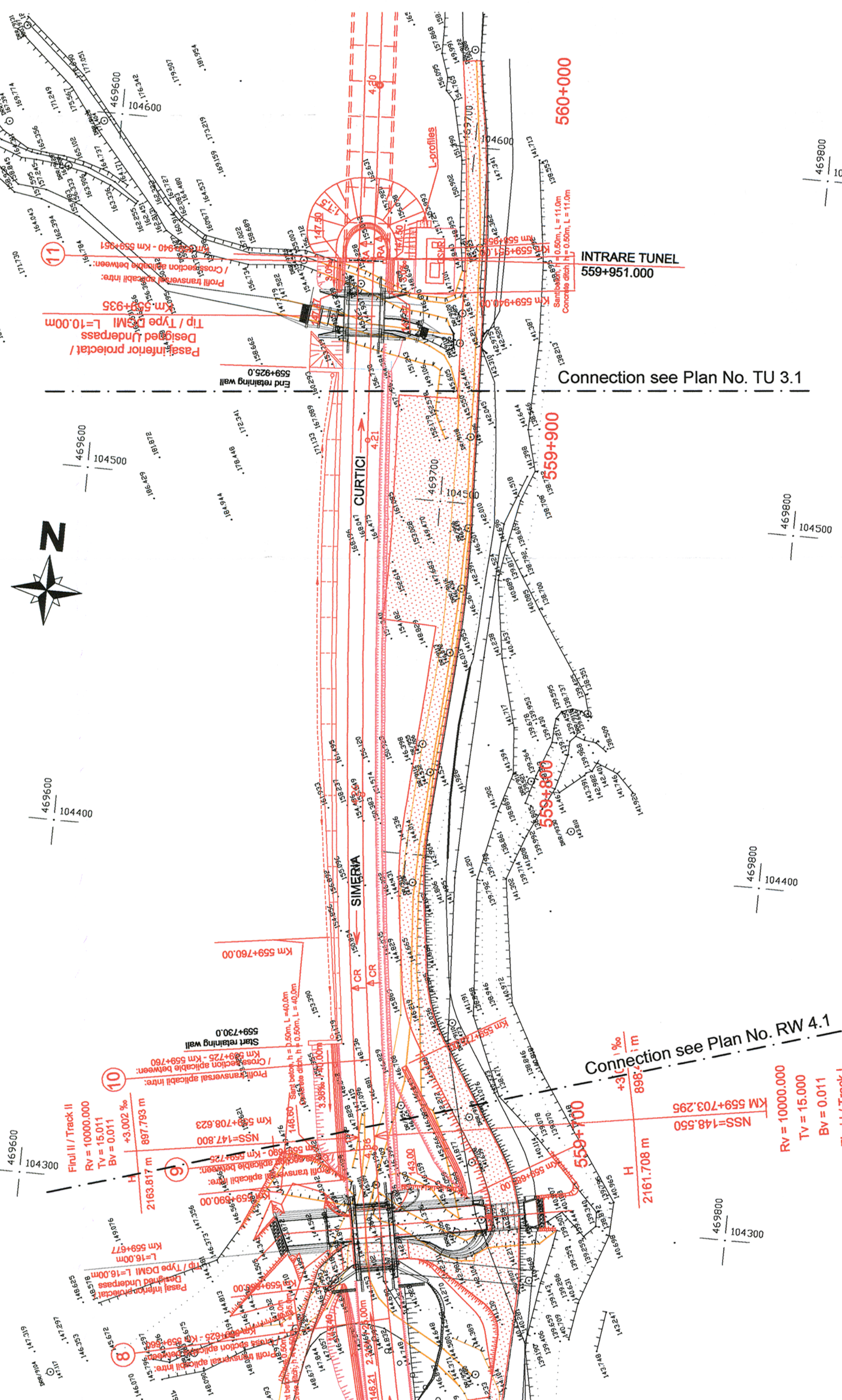

**NOTE:**

- This plan was prepared based on the following data:
  - topographic survey; geotechnical study; technical expertise; data collected on the site;
- In order to make the retaining walls, the following works will be carried -out:
  - Excavation pit from top to floor and supporting the slopes with shotcrete and micropiles
  - Installation of drainage pipe and drainage matting
  - Construct of the final shell from bottom to top
  - Construction of the drainage ditch at the top
  - Mounting of the handrail
  - Rectification of the upper slope
- During the execution, the provisions of the following documents will be strictly observed:
  - Practice code for the execution of works made of concrete, reinforced concrete and prestressed concrete, indicative NE 012-2007;
  - Practice code for the execution of the precast elements made of concrete, reinforced concrete and prestressed concrete, indicative NE 013-2002;
  - Normative for quality checking and taking over of afferent construction works, indicative C56-85
  - The Technical Specifications.
- Complying with H.G. 766/1997 this structure belongs to category "B" of importance.
- The project will be verified at A.4, B.2 and D.2 requirements.

**OBSERVATE:**

- Pe toate suprafețele din beton în contact cu pământul se vor aplica 2 straturi de emulsie din bitum filerizat.
- Protecția betonată a albă se va executa cu rosturi conform C.S.

**ATTENTION:**

- All concrete surfaces in contact with soil will be coated with 2 bituminous layers.
- The concrete protection of the riverbed will be executed with joints according with technical specifications.

**NOTA:**

Pentru trasarea lucrărilor se vor folosi ca repere în plan axele liniilor c.f. iar ca repere de nivel cota NSS(Pr.).

**NOTA:**

For setting out the works, the axes of the railway lines will be utilized as reference marks in plan and the NSS(Dsg.)(top of the rail).

Longitudinal section	M 1:1000	RW 5.2
Regular Cross section, H = 0 to 7 m	M. 1:50	RWC 1
Regular Cross section, H = 7 to 13 m	M. 1:50	RWC 2
Regular Cross section, H = 13 to 15 m	M. 1:50	RWC 3
Regular Cross section, H = 15 to 19 m	M. 1:50	RWC 4
Regular Cross section, H = 19 to 22.5 m	M. 1:50	RWC 5
Details	M. 1:10, 1:25	RWD 1

ROMANIA  
MUNICIPIUL SIMERIA  
VERIFICATOR  
MR. 1322

ROMANIA  
MUNICIPIUL CURTICI  
VERIFICATOR  
MR. 1322

ROMANIA  
MINISTERUL  
TRANSPORTURILOR

European  
Investment  
Bank

COMPANIA NAȚIONALĂ DE CĂI FERATE "CFR" SA

PROIECTANT / DESIGNER:

Verificator / Expert  
Checker / Expert

Semnatura  
Signature

Referat / Expertiza  
Report / Expertise

BENEFICIAR / BENEFICIARY :

COMPANIA NAȚIONALĂ DE CĂI FERATE "CFR" SA

APROBAT Approved	Sef de echipa Team leader	C. Teodorescu	Data Date	06/2013	Semnatura Signature	
VERIFICAT Checked	Expert Cheie Key Expert	M. Diegmann		06/2013		
APROBAT Approved	Adjunct Sef de echipa Deputy Team leader	J. Werfling		06/2013		
PROIECTAT Designed	Inginer Engineer	D. Ciotarnel		06/2013		

"Reabilitarea liniei c.f. Frontieră - Curtici - Simeria, parte componentă a coridorului IV Pan - European pentru circulația trenurilor cu viteză maximă de 160 km/h"  
Tronsoanel 2: km 614-Gurasada

"Rehabilitation of the Railway Line Border - Curtici - Simeria, component Part of the IV Pan - European Corridor for the Trains Circulation with maximum speed of 160 km/h"  
Section 2 :km 614-Gurasada

Denumire desen / Drawing name:  
PLAN DE SITUATIE  
LAYOUT PLAN - RETAINING WALL RW 5  
km 559+730 - km 559+925

Scara / Scale 1:1000	Cod desen / Drawing Code RW 5.1	Nr / No RW 5
-------------------------	------------------------------------	-----------------